







-  szacht instalacyjny, brak możliwości przebudowy
-  ściana działowa, możliwa przebudowa
-  ściana nośna, brak możliwości przebudowy



0 1 2 3 4 5m  
skala 1:100

APARTAMENT	A7
TYP	1P+AK
PIĘTRO	PARTER
POWIERZCHNIA	110,50 m <sup>2</sup>
POW. KONDYGNACJI	46,86 m <sup>2</sup>

## BIURO SPRZEDAŻY

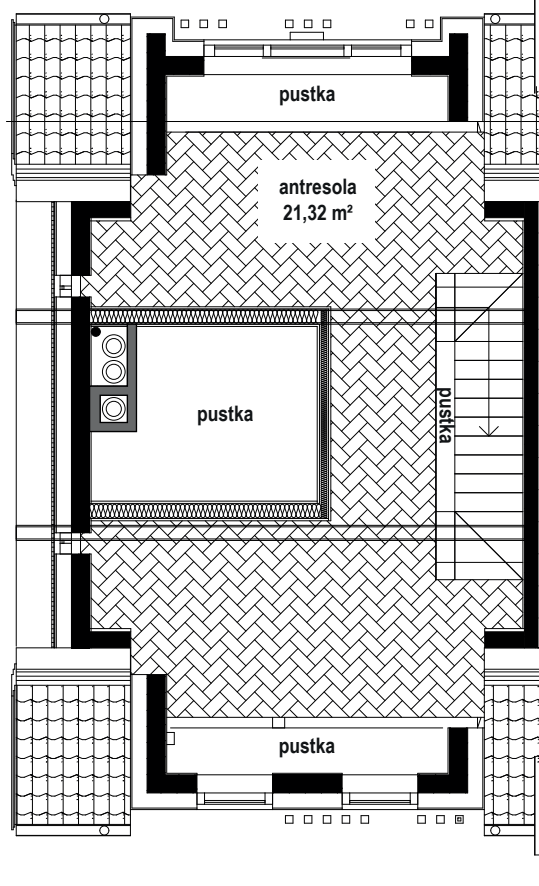
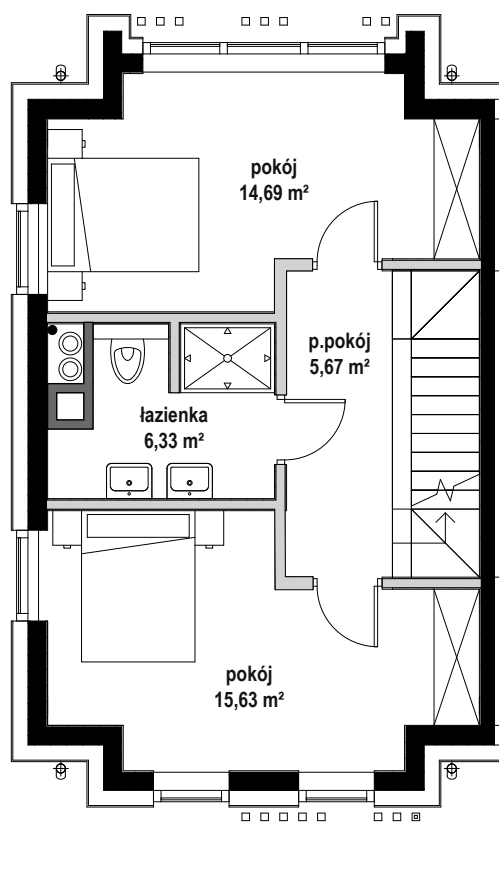
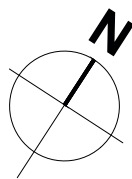
-  886 478 730
-  [www.rydzeworesidence.pl](http://www.rydzeworesidence.pl)
-  [biuro@rydzeworesidence.pl](mailto:biuro@rydzeworesidence.pl)
-  Rydzewo, ul. Mazurska 50







-  szacht instalacyjny, brak możliwości przebudowy
-  ściana działowa, możliwa przebudowa
-  ściana nośna, brak możliwości przebudowy

  
 skala 1:100

APARTAMENT	A7
TYP	2P/ ANTRESOLA
PIĘTRO	PIĘTRO 1/ ANTRESOLA
POWIERZCHNIA	110,50 m <sup>2</sup>
POW. KONDYGNACJI	42,32 m <sup>2</sup> / 21,32 m <sup>2</sup>

## BIURO SPRZEDAŻY

-  886 478 730
-  [www.rydzeworesidence.pl](http://www.rydzeworesidence.pl)
-  [biuro@rydzeworesidence.pl](mailto:biuro@rydzeworesidence.pl)
-  Rydzewo, ul. Mazurska 50